

Equipment: Carpet Cleaning Machines > Vacuum Cleaners > HEPA Concrete Dust Slurry Hazmat Vacuums >

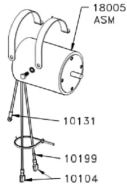

Model Number: 18005

Brush Motor Assembly 18005 for Equipure Kent C4

Manufacturer: Equipure Carpet Cleaners

Replacement Beater Brush Motor Assembly for Kent C4 or Kent Equipure SC4

-Item 18005 ASM in diagram

-Includes:

- 18005- Motor, Brush C-4 115 Volt, Unwired
- 10104- Terminal, Spade, Male
- 10131- Terminal, Ring #10
- 10199- Tag, Wire B/Brush Motor (C4)

Compare to current or past OEM associations

18005

Flojet 2027-092-115

2019-092-115

CD-52530A

Availability: This product was added to our catalog on Tuesday 30 October, 2018